



# Apeiron<sup>™</sup>SERIES

LED BASED MARINE  
DOWN LIGHTS

SDi

SDi<sub>HB</sub>

SDi<sub>TRI-LIGHT</sub>

**i2Systems**<sup>®</sup>  
ADVANCED LED LIGHTING

ACCUWHITE<sup>™</sup>

# Apeiron™ SERIES

## LED BASED MARINE DOWN LIGHTS

<b>SDi</b>	Available in the most configurations of any Apeiron
<b>SDiHB</b>	High brightness white and warm white LED
<b>SDiTRI-LIGHT</b>	Up to 3 colors in one fixture for dramatic color effects



shown: Apeiron SDi HB, Warm White

## FIXTURE COMPARISON

	SDi	SDiHB	SDiTRI-LIGHT
STYLE	SPRING MOUNT AVAILABLE	●	●
	SCREW MOUNT AVAILABLE	●	
COLOR	COLORS PER FIXTURE	1	1
	COLORS AVAILABLE	9	2
USAGE	LARGE AREA DOWN LIGHT		●
	SMALL AREA DOWN LIGHT	●	
	EXTERIOR DOWN LIGHT	●	●
FEATURES	ACCUWHITE	●	●
	0 to 100% DIMMING	●	●
ELECTRICAL	INPUT VOLTAGE (V <sub>in</sub> )	6-30V DC*	6-30V DC*
	INPUT POWER (P <sub>in</sub> )	1.5W	4W
	SMARTDRIVER™ INSIDE	●	●
	PROTECTION FEATURES	Reverse Polarity Protection Transient Protection	Internal Auto-Resettable Fuse Reverse Polarity Protection Transient Protection

### ACCUWHITE™

i2Systems AccuWhite technology allows integration of Apeiron fixtures to traditional halogen applications without sacrifice in color temperature (CCT) or color rendering (CRI).

### CERTIFIED



**IP67**  
WATERPROOF



DIRECTIVE  
94/25/EC



CLASS B

PATENT  
PENDING

\*Light fixture will maintain 100% intensity provided the input voltage to the light fixture is within the voltage range above. Do Not exceed the maximum Input Voltage rating. Refer to product instructions for detailed installation requirements and specifications.  
i2Systems reserves the right to make changes at any time.

**APEIRON SDi HB**  
HALOGEN



**HOURS OF OPERATION**

hours of operation are approximate and may vary under individual circumstances.

**4 WATTS**



**POWER CONSUMPTION**

**130°F (54°C)**



**TEMPERATURE**

temperatures are approximate and will vary based on fixture installation and ambient temperature conditions. Refer to product instructions for additional information.

# MOUNTING OPTIONS

## SPRING MOUNT

### EVEN LIGHT

Advanced Optical System  
120° Full Angle  
No LED Dots

Stainless Steel Trim Ring

Stainless Steel  
Spring Clips

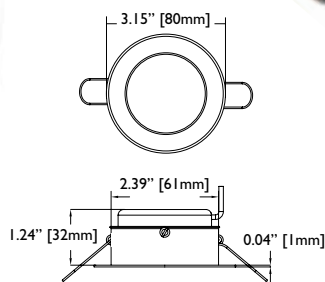

### SMARTDRIVER™ INTEGRATED

With SmartDriver technology, light output remains at 100% intensity over entire operating voltage range.

0 to 100% Digital Dimming

### ADVANCED THERMAL DESIGN

Anodized aluminum housing, completely sealed. (IP67)



Side-Emerging Wires,  
18 AWG

### SPRING MOUNT AVAILABLE FOR:

SDi  
SDi HB  
SDi TRI-LIGHT

### FINISHES

Available for both  
mounting options.



Polished Chrome



Polished Gold



Powder Coated  
White



Brushed Nickel



Powder Coated  
Off-White

## SCREW MOUNT

### EVEN LIGHT

Advanced Optical System  
120° Full Angle  
No LED Dots

Interchangeable,  
Stainless Steel Trim Ring

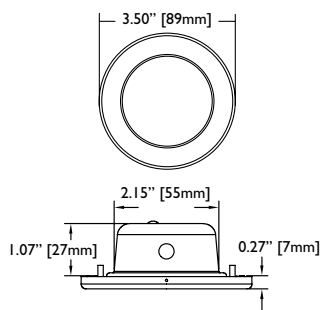

### SMARTDRIVER™ INTEGRATED

With SmartDriver technology, light output remains at 100% intensity over entire operating voltage range.

0 to 100% Digital Dimming

### ADVANCED THERMAL DESIGN

Powder coated stainless steel housing, completely sealed. (IP67)



Side-Emerging Wires,  
18 AWG

### SCREW MOUNT AVAILABLE FOR:

SDi  
SDi TRI-LIGHT

i2Systems reserves the right to make changes at any time.

## LIGHTING LOCATION TIP

### INTERIOR LIGHTING

#### WARM WHITE

Warm color temperatures and high color rendering make wood and fabrics look warm and inviting.

### EXTERIOR LIGHTING

#### COOL WHITE OR COLORS

Cool white creates a fresh, new appearance. Vibrant colors create unique effects never before possible.

**i2Systems**<sup>®</sup>  
ADVANCED LED LIGHTING

# PART NUMBERING

Using the key to the right, match X,Y and Z to put together the perfect Apeiron fixture for your project. Keep in mind not all housings and color options are available for all fixture types.

## SDi

AP (X) - (Y) L - SDI - (Z) 1

## SDi HB

AP - (Y) HB - SDI - (Z) 1

## SDi TRI-LIGHT

AP (X) - (YYY) L - SDI - (Z) 1

Dual color Tri-Lights are also available, however are configured as "off, color 1, color 2, off, off, color 1, etc." This will allow two color Tri-Lights to remain synchronized with three color Tri-Lights.

### (X) HOUSING

L SCREW MOUNT  
ie: APL-YL-SDI-Z1

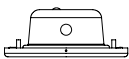

- SPRING MOUNT  
(LEAVE BLANK)  
ie: AP-YL-SDI-Z1

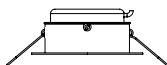

### (Y) LED COLORS

- 1 WHITE
- 2 WARM WHITE
- 3 GREEN
- 4 BLUE
- 5 ROYAL BLUE
- 6 CYAN
- 7 RED
- 8 RED-ORANGE
- 9 AMBER

AVAILABILITY:  
SDi: 1-9 (ALL)  
SDi HB: 1, 2  
SDi TRI-LIGHT: 1, 2, 3, 4, 7

### (Z) FINISH

- 1  POLISHED CHROME
- 2  POLISHED GOLD
- 3  POWDER COATED WHITE
- 4  BRUSHED NICKEL
- 5  POWDER COATED OFF-WHITE

# WIRING DIAGRAMS

Refer to product instructions for additional information.

## SINGLE COLOR

APPLIES TO:  
APEIRON SDi  
APEIRON SDi HB

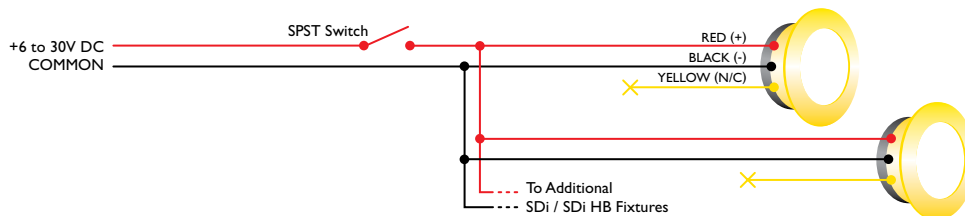

## SINGLE COLOR WITH DIMMING

APPLIES TO:  
APEIRON SDi  
APEIRON SDi HB

Dimming module shown in momentary (MOM) switch dimming configuration, other standard configurations available.

When installing to digital control systems, dimming module may not be required. Consult i2Systems for additional information.

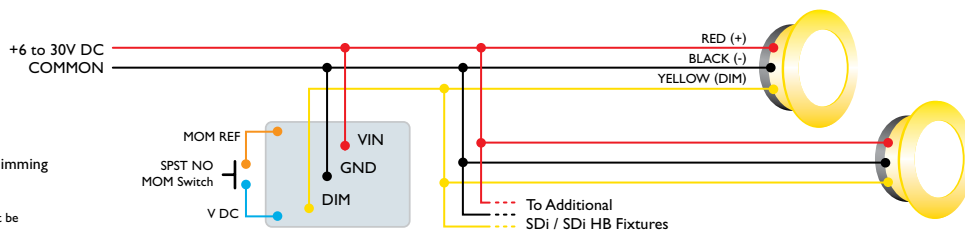

## MULTIPLE COLOR

APPLIES TO:  
APEIRON SDi TRI-LIGHT

To change colors, momentarily open the +9 to 30V DC input to the fixtures for 1 second or less. The fixture colors will cycle color 1, color 2, color 3, off, color 1 etc.

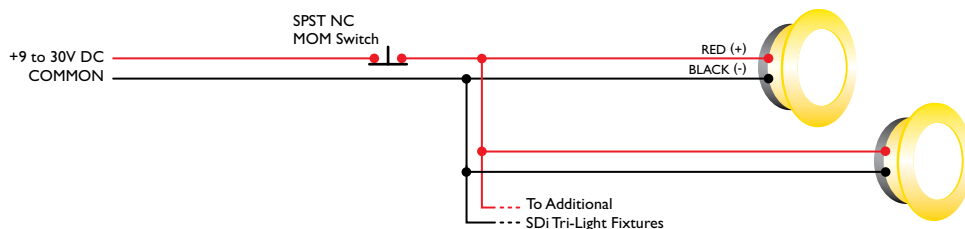

i2Systems® is a leading solid state lighting designer, manufacturer and systems developer. The company's core technology enables the next generation of illumination, continuing to change the way we light the world.

Through progressive research and innovation, i2Systems transforms conventional lighting applications with solid state lighting and offers a myriad of industries highly versatile, controllable, energy efficient and long lasting lighting solutions.

The company is headquartered in Morris, CT. More information regarding i2Systems and its products are available at [www.i2systems.com](http://www.i2systems.com)

**ADVANCED LED LIGHTING**  
[www.i2systems.com](http://www.i2systems.com)

Integrated Illumination Systems, Inc. • 355 Bantam Lake Road • Morris, CT • 06763 • USA  
tel +1-860-567-0708 • fax +1-860-567-2501 • sales@i2systems.com • www.i2systems.com

i2Systems reserves the right to make changes at any time.